

## S-Carb End Mills



### 47ES

FRACTIONAL SERIES

TECH INFO 92

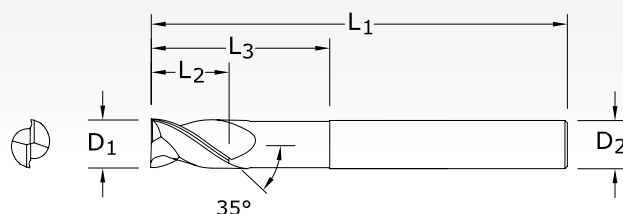

inch					EDP NO.	
CUTTING DIAMETER D <sub>1</sub>	LENGTH OF CUT L <sub>2</sub>	OVERALL LENGTH L <sub>1</sub>	SHANK DIAMETER D <sub>2</sub>	REACH L <sub>3</sub>	UNCOATED	TI-NAMITE-B (TiB <sub>2</sub> )
1/4	3/8	4	1/4	2-1/8	34640	34678
3/8	1/2	4	3/8	2-1/8	34641	34679
1/2	5/8	6	1/2	2-1/8	34642	34680
1/2	5/8	6	1/2	3-3/8	34643	34681
5/8	3/4	6	5/8	2-3/8	34644	34682
5/8	3/4	6	5/8	3-3/8	34645	34683
3/4	1	6	3/4	2-1/2	34646	34684
3/4	1	6	3/4	3-3/8	34647	34685

#### TOLERANCES (inch)

##### 1/4–3/8 DIAMETER

D<sub>1</sub> = +0.0000/–0.00035

D<sub>2</sub> = h<sub>6</sub>

##### 1/2–5/8 DIAMETER

D<sub>1</sub> = +0.0000/–0.00043

D<sub>2</sub> = h<sub>6</sub>

##### 3/4–1 DIAMETER

D<sub>1</sub> = +0.0000/–0.00051

D<sub>2</sub> = h<sub>6</sub>

### 47MES

METRIC SERIES

TECH INFO 94

mm					EDP NO.	
CUTTING DIAMETER D <sub>1</sub>	LENGTH OF CUT L <sub>2</sub>	OVERALL LENGTH L <sub>1</sub>	SHANK DIAMETER D <sub>2</sub>	REACH L <sub>3</sub>	UNCOATED	TI-NAMITE-B (TiB <sub>2</sub> )
6,0	10,0	100,0	6,0	54,0	44561	44609
8,0	12,0	100,0	8,0	54,0	44562	44610
10,0	12,0	100,0	10,0	54,0	44563	44611
12,0	16,0	150,0	12,0	80,0	44564	44612
16,0	20,0	150,0	16,0	80,0	44565	44613
20,0	25,0	150,0	20,0	80,0	44566	44614

#### TOLERANCES (mm)

##### 6 DIAMETER

D<sub>1</sub> = +0,000/–0,008

D<sub>2</sub> = h<sub>6</sub>

##### >6–10 DIAMETER

D<sub>1</sub> = +0,000/–0,009

D<sub>2</sub> = h<sub>6</sub>

##### >10–18 DIAMETER

D<sub>1</sub> = +0,000/–0,011

D<sub>2</sub> = h<sub>6</sub>

##### >18–20 DIAMETER

D<sub>1</sub> = +0,000/–0,013

D<sub>2</sub> = h<sub>6</sub>