

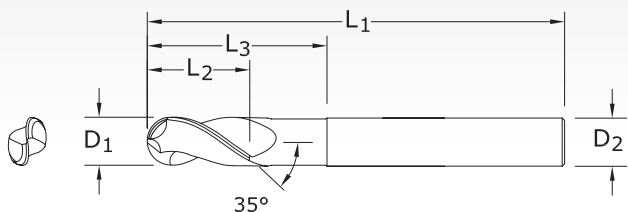

S-Carb End Mills



TOLERANCES (inch)

1/4-3/4 DIAMETER

$$D_1 = +0.0001/-0.0004$$
$$D_2 = h_6$$

47EB
FRACTIONAL SERIES

inch					EDP NO.	
CUTTING DIAMETER D ₁	LENGTH OF CUT L ₂	OVERALL LENGTH L ₁	SHANK DIAMETER D ₂	REACH L ₃	UNCOATED	Ti-NAMITE-B (TiB ₂)
1/4	3/8	4	1/4	2-1/8	34650	34686
3/8	1/2	4	3/8	2-1/8	34651	34687
1/2	5/8	6	1/2	2-1/8	34652	34688
1/2	5/8	6	1/2	3-3/8	34653	34689
5/8	3/4	6	5/8	3-3/8	34654	34690
5/8	3/4	6	5/8	2-3/8	34655	34691
3/4	1	6	3/4	2-1/2	34656	34693
3/4	1	6	3/4	3-3/8	34657	34692

TECH INFO 71

NON-FERROUS

PLASTICS/COMPOSITES

TOLERANCES (mm)

6-20 DIAMETER

$$D_1 = +0,0025/-0,010$$
$$D_2 = h_6$$

47MEB
METRIC SERIES

mm					EDP NO.	
CUTTING DIAMETER D ₁	LENGTH OF CUT L ₂	OVERALL LENGTH L ₁	SHANK DIAMETER D ₂	REACH L ₃	UNCOATED	TI-NAMITE-B (TiB ₂)
6,0	10,0	100,0	6,0	54,0	44581	44615
8,0	12,0	100,0	8,0	54,0	44582	44616
10,0	12,0	100,0	10,0	54,0	44583	44617
12,0	16,0	150,0	12,0	80,0	44584	44618
16,0	20,0	150,0	16,0	80,0	44585	44619
20,0	25,0	150,0	20,0	80,0	44586	44620

TECH INFO 71