

# S-Carb End Mills



## 43L

FRACTIONAL SERIES

TECH INFO 71

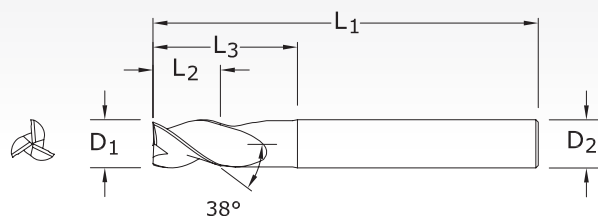

NON-FERROUS  
PLASTICS/COMPOSITES

CUTTING DIAMETER D <sub>1</sub>	LENGTH OF CUT L <sub>2</sub>	inch			EDP NO.	
		OVERALL LENGTH L <sub>1</sub>	SHANK DIAMETER D <sub>2</sub>	REACH L <sub>3</sub>	UNCOATED	Ti-NAMITE-B (TiB <sub>2</sub> )
1/8	5/32	3	1/8	1/2	32700	32725
3/16	7/32	3	3/16	1/2	32701	32726
1/4	3/8	4	1/4	3/4	32702	32727
1/4	3/8	4	1/4	1-1/2	32703	32728
1/4	3/8	4	1/4	2-1/8	32704	32729
5/16	7/16	4	5/16	1-1/8	32705	32730
5/16	7/16	4	5/16	2-1/8	32706	32731
3/8	1/2	4	3/8	1-1/8	32707	32732
3/8	1/2	4	3/8	2-1/8	32708	32733
1/2	5/8	4	1/2	1-3/8	32709	32734
1/2	5/8	6	1/2	2-1/8	32710	32735
1/2	5/8	6	1/2	3-3/8	32711	32736
5/8	3/4	4	5/8	1-3/4	32712	32737
5/8	3/4	4	5/8	2-3/8	32713	32738
5/8	3/4	6	5/8	3-3/8	32714	32739
3/4	1	4	3/4	1-3/4	32715	32740
3/4	1	6	3/4	2-3/8	32716	32741
3/4	1	6	3/4	3-3/8	32717	32742
1	1-1/4	6	1	2-3/8	32718	32743
1	1-1/4	6	1	3-3/8	32719	32744
1	1-1/4	7	1	4-3/8	32720	32745

### TOLERANCES (inch)

#### 1/8-3/16 DIAMETER

D<sub>1</sub> = +0.000/-0.00032

D<sub>2</sub> = h<sub>6</sub>

#### 1/4-3/8 DIAMETER

D<sub>1</sub> = +0.000/-0.00035

D<sub>2</sub> = h<sub>6</sub>

#### 1/2-5/8 DIAMETER

D<sub>1</sub> = +0.000/-0.00043

D<sub>2</sub> = h<sub>6</sub>

#### 3/4-1 DIAMETER

D<sub>1</sub> = +0.000/-0.00051

D<sub>2</sub> = h<sub>6</sub>

