

# T-Carb End Mills

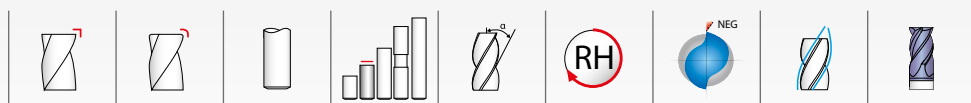

## 51M

METRIC SERIES

TECH INFO 48

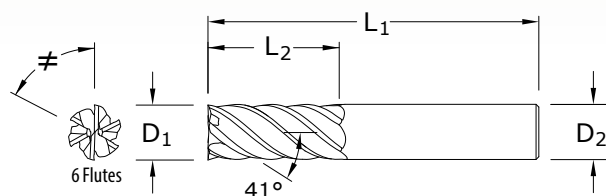
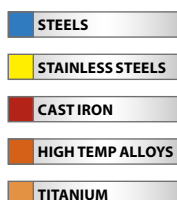

TOLERANCES (mm)

6-20 DIAMETER

 $D_1 = +0,000/-0,050$  $D_2 = h_6$ 

mm				EDP NO.
CUTTING DIAMETER $D_1$	LENGTH OF CUT $L_2$	OVERALL LENGTH $L_1$	SHANK DIAMETER $D_2$	Ti-NAMITE-X (AlTiN)
6	19	63	6	45100
8	20	63	8	45101
10	22	75	10	45102
12	26	83	12	45103
16	32	92	16	45104
20	38	104	20	45105

## 51MCR

METRIC SERIES

TECH INFO 48

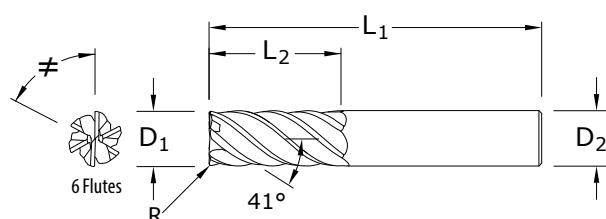
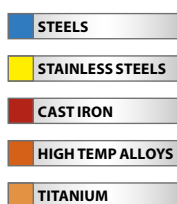

TOLERANCES (mm)

6-20 DIAMETER

 $D_1 = +0,000/-0,050$  $D_2 = h_6$ 

CORNER RADIUS

TOLERANCES (mm)

 $R = +0,000/-0,050$ 

mm					EDP NO.
CUTTING DIAMETER $D_1$	LENGTH OF CUT $L_2$	OVERALL LENGTH $L_1$	SHANK DIAMETER $D_2$	CORNER RADIUS $R$	Ti-NAMITE-X (AlTiN)
6	19	63	6	0,5	45112
8	20	63	8	0,5	45113
8	20	63	8	1,0	45114
10	22	75	10	1,0	45115
10	22	75	10	1,5	45116
10	22	75	10	2,0	45117
12	26	83	12	1,0	45118
12	26	83	12	1,5	45119
12	26	83	12	2,0	45120
16	32	92	16	1,0	45121
16	32	92	16	1,5	45122
16	32	92	16	2,0	45123
20	38	104	20	1,0	45124
20	38	104	20	1,5	45125
20	38	104	20	2,0	45126

Any radii available – 7-10 day delivery