

Z-Carb-MD End Mills

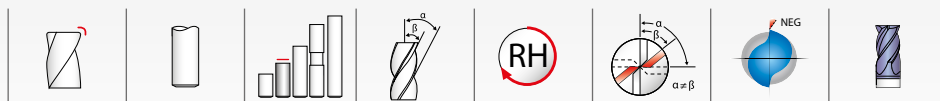

ZD1MCR

METRIC SERIES

TECH INFO 29

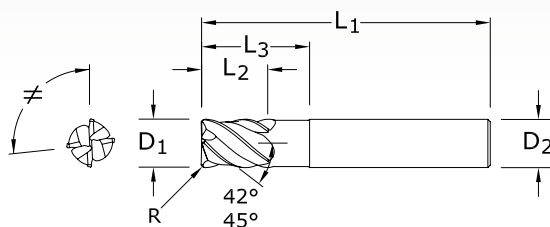

TOLERANCES (mm)

3-6 DIAMETER

$D_1 = +0,000/-0,030$
 $D_2 = h_6$
 $R = +0,000/-0,050$

>6-10 DIAMETER

$D_1 = +0,000/-0,040$
 $D_2 = h_6$
 $R = +0,000/-0,050$

>10-20 DIAMETER

$D_1 = +0,000/-0,050$
 $D_2 = h_6$
 $R = +0,000/-0,050$

mm						EDP NO.
CUTTING DIAMETER D_1	LENGTH OF CUT L_2	OVERALL LENGTH L_1	SHANK DIAMETER D_2	REACH L_3	CORNER RADIUS R	Ti-NAMITE-A (AlTiN)
3,0	4,0	57,0	6,0	15,0	0,2	46560
4,0	5,0	57,0	6,0	15,0	0,3	46561
5,0	6,0	57,0	6,0	15,0	0,5	46562
6,0	7,0	57,0	6,0	15,0	1,0	46563
8,0	10,0	63,0	8,0	25,0	1,0	46564
10,0	12,0	72,0	10,0	30,0	1,0	46565
12,0	15,0	83,0	12,0	35,0	1,0	46566
16,0	20,0	92,0	16,0	45,0	1,5	46567
20,0	24,0	104,0	20,0	55,0	2,0	46568

Any radii available – 7-10 day delivery

STEELS

HARDENED STEELS